

additional elevators placed in the 80s:
disruptive verticality

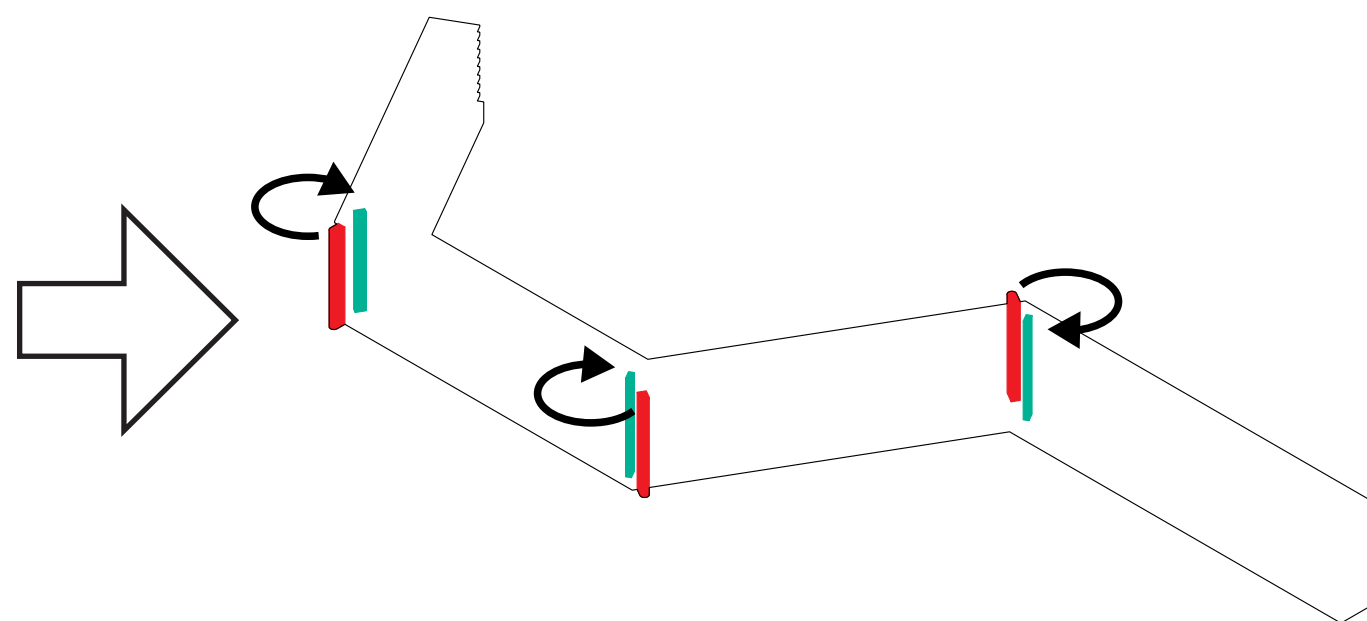

concrete additions removed: new elevators placed
inside the existing cores

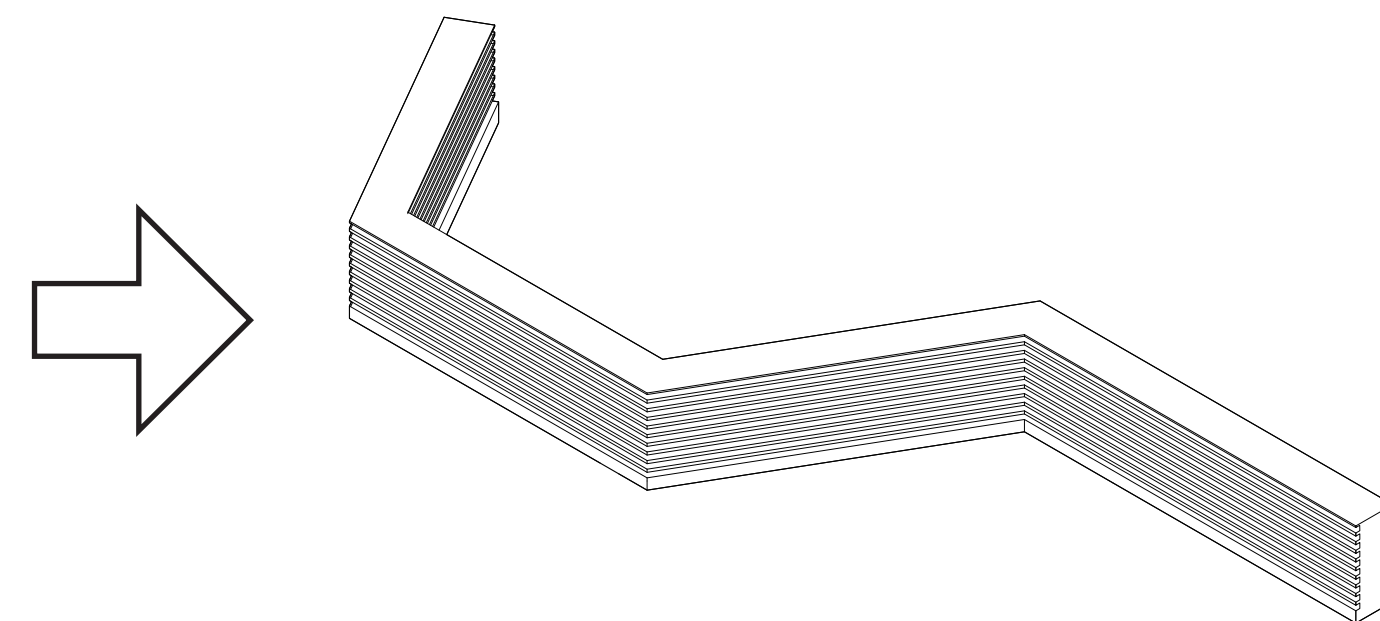

stacked 'streets in the sky', horizontal continuity:
BLISS

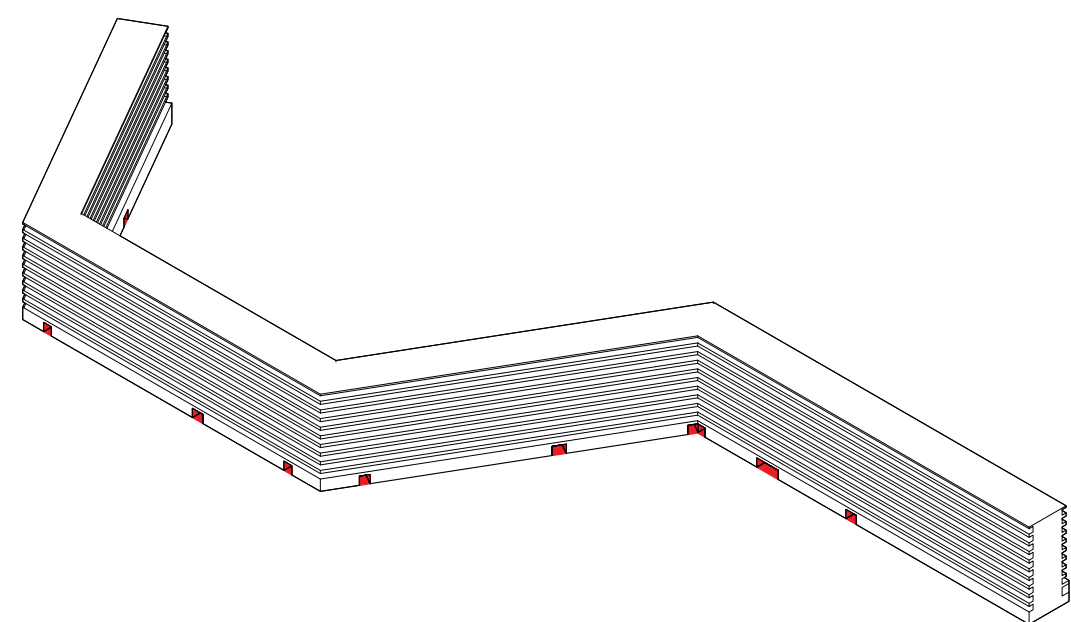

many small underpasses: limited in height by the
'interior street' at +3meter

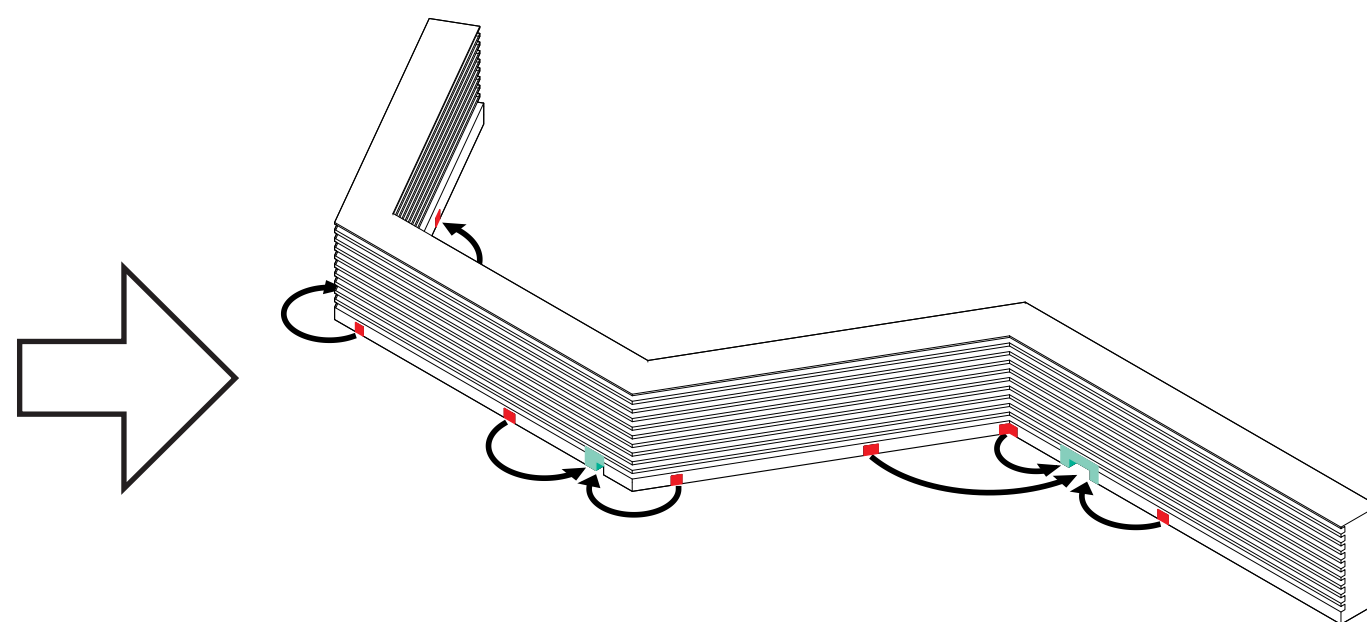

interior street obsolete: regrouping of underpasses to
create larger openings

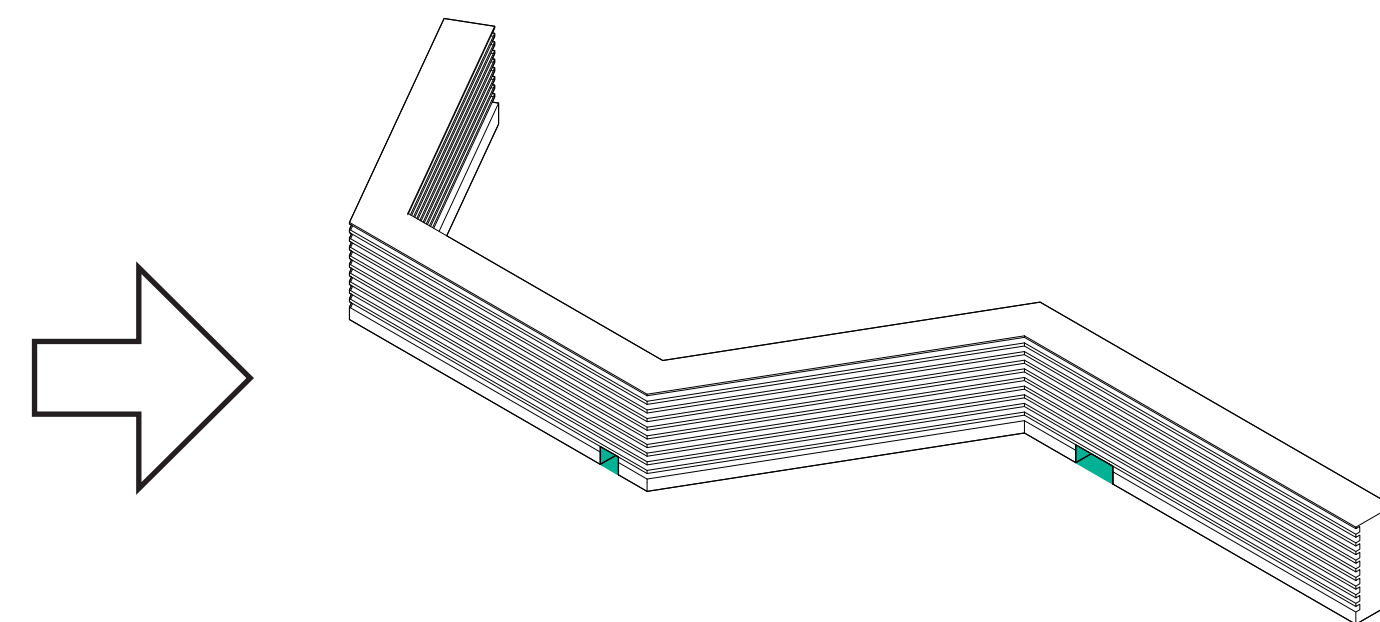

new perforations: scenic and generous

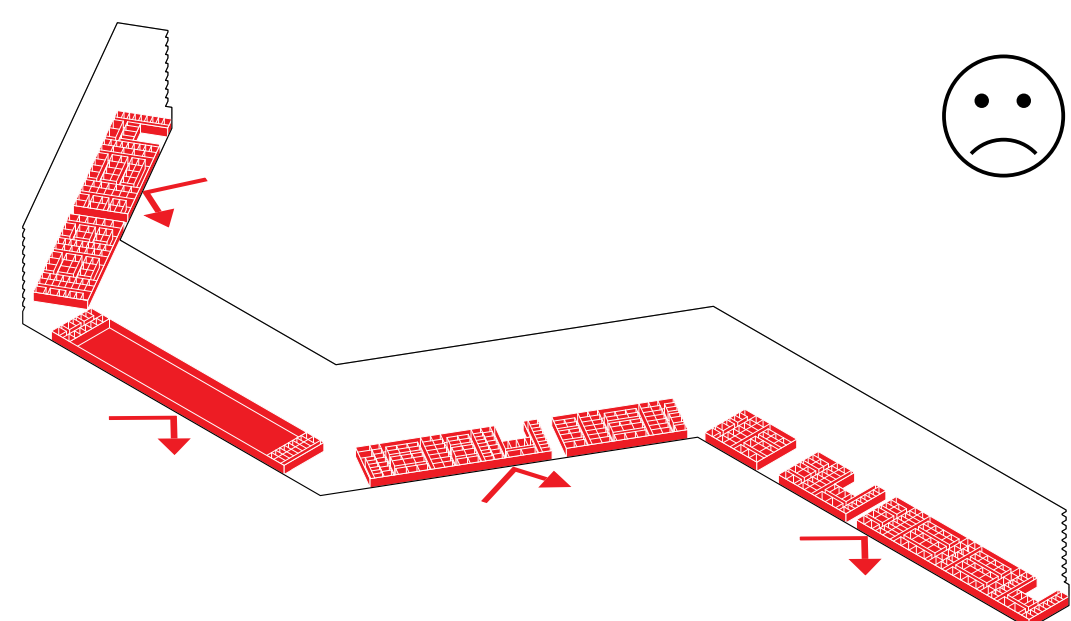

impenetrable storage spaces on ground level:
'dead zone' at the foot of the building

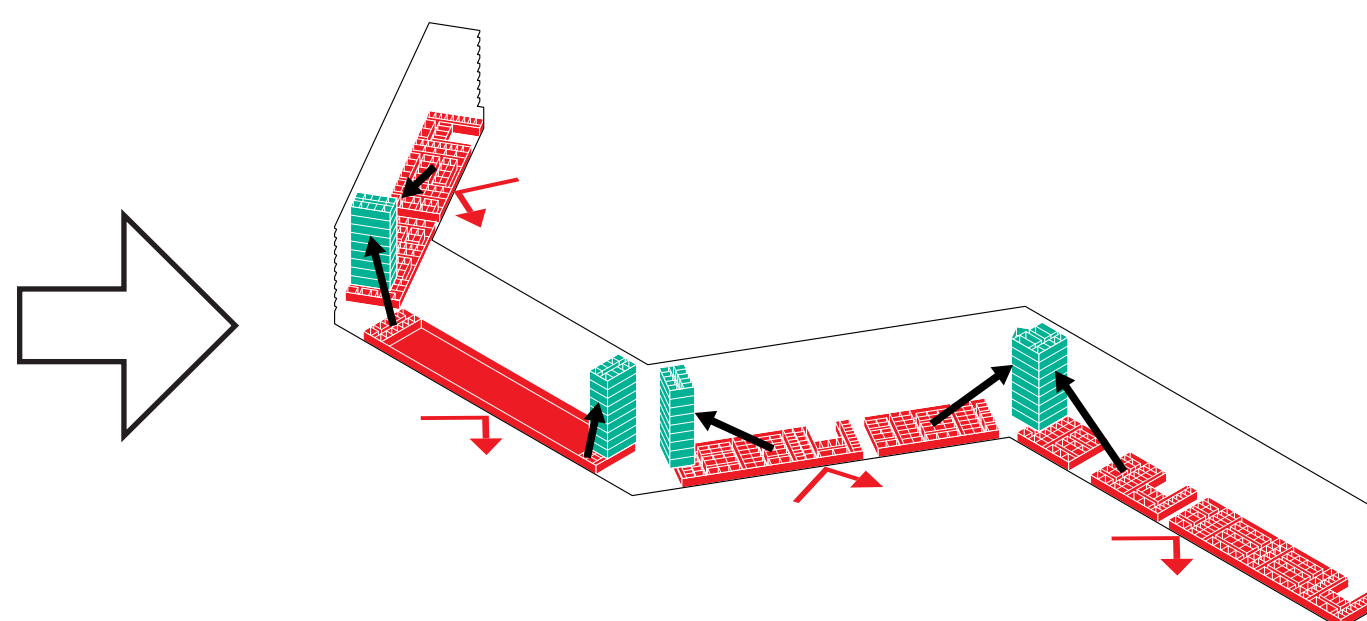

relocating storage spaces to upper levels: ground
level free for more interactive inhabitation

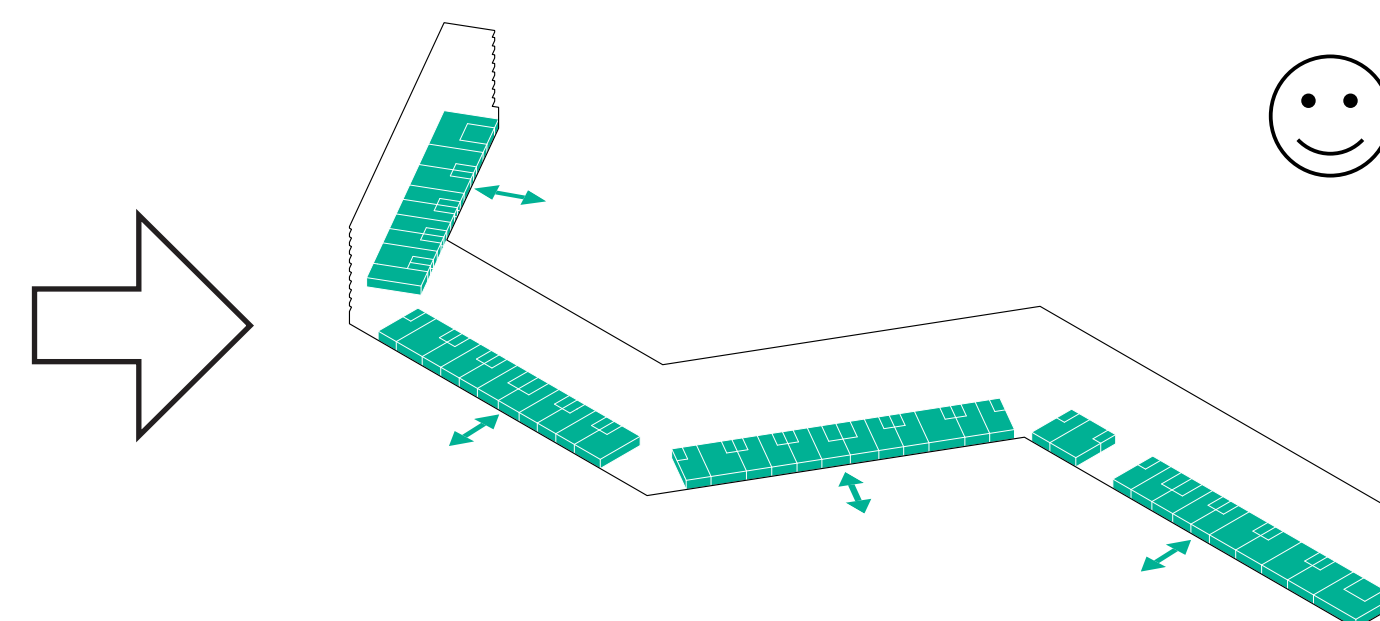

plinth activated, dwellings and workspaces at
ground level: friendly interface